



# VIVENTE

## INFORMATION PACK

# CONTENTS

INTRODUCTION	3
KEY SELLING FEATURES	4
REMOTE FUNCTIONALITY	5
FLAME CONNECT APP	6
UNIT AND INSTALLATION INFORMATION	7
SUPPORTING COLLATERAL	8

# INTRODUCTION

Vivente is the latest in electric flame innovation from Real Flame. With a choice of 750, 1000, and 1500mm widths, the product is sized to suit a range of applications from small apartments to grand entertaining areas. The clever design enables the choice of creating a 1, 2, or 3-sided configuration when the product is being installed, while anti-reflective glass avoids unwanted reflections impacting upon the stunning flame effect. It is this Revillusion flame effect that truly sets Vivente apart – by removing the central mirror seen in traditional electric fires, Revillusion increases the visible depth of the firebox and allows the firebox lining to be changed to suit your interior design theme. There are 4 finish options included as standard – ribbed, tiled, stacked stone, and plain black, you can even customise your own panel to suit. Vivente's unrivalled features include SmartSense motion sensing technology, heating, and a multitude of flame colour and sensory options such as the crackle of a real fire. These settings can be controlled either with the on-board controls, the remote control, or the Flame Connect App (available for Android and iOS). If you think you know electric flame, think again - welcome to the future.

The information pack contains everything that you need to know about this new dazzling fireplace.

For more information please refer to the electric fireplace IOM or contact your Real Flame representative.

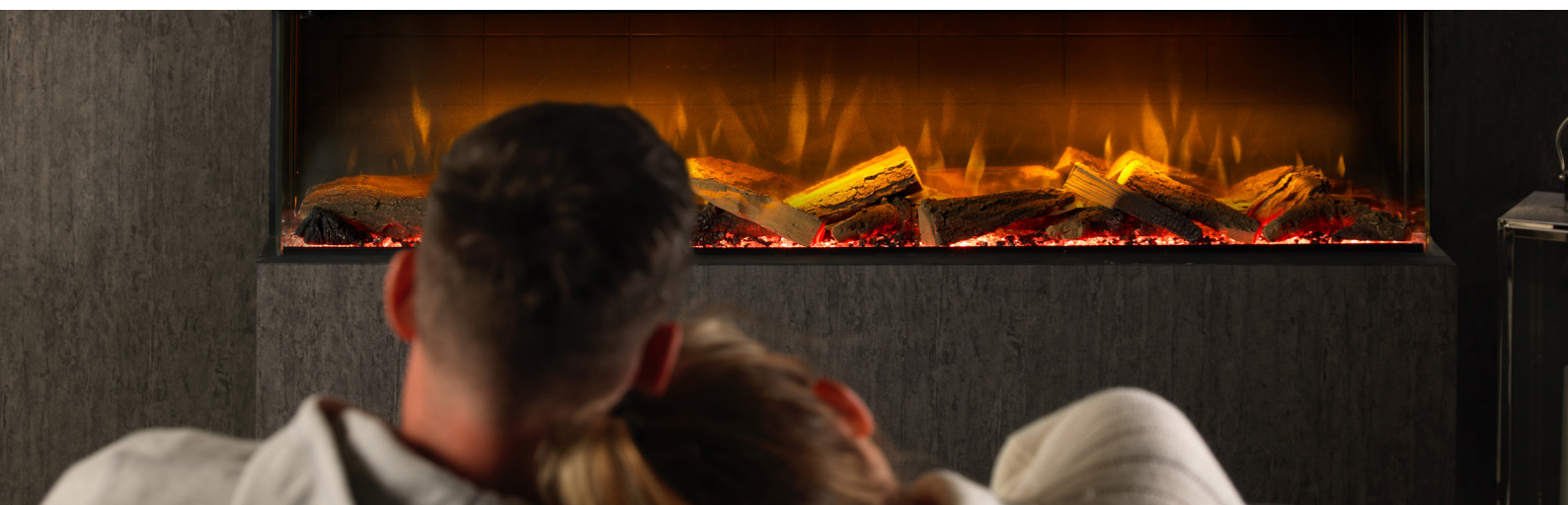



## KEY SELLING FEATURES



4 Viewing configurations included as standard.



8 ambient lighting themes built-in, with the option to fully customise your own theme through the app.



Revillusion flame technology doubles the visual depth of the firebox.



Colour-changing flame effects



Flame Connect App available for your smartphone.



4 back panel options to suit your décor.



Vivente Range starting from \$2,599, refer to the price list for full details.



2 fuel bed options – traditional ceramic log set and clear crystals.



ComfortSaver - energy efficient 1.5kW heater, offering up to 11% saving.



Anti-reflective glass



SmartSense technology to detect room movement.



Real flame crackling sound effect.



7-day programmable timer.

### MULTIPLE FUEL BED THEMES



Green



Blue



Red



Light Blue



Purple

and many more

### BACK PANEL OPTIONS

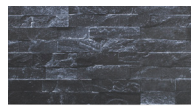

Stone

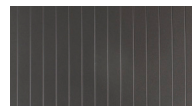

Ribbed

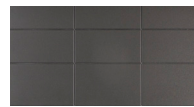

Tiled

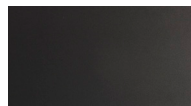

Black

## REMOTE FUNCTIONALITY

### Power Button

Switches the product on and off. Restores to previous setting when switched on.

### SmartSense motion sensing cycle

Vivente switches on and off depending on the room movement. Cycle between various motion intervals from 0.5 to 3hrs.

### Temperature Down

Press this button to decrease the temperature. Lowest temperature can be set to 15°C.

### Flame brightness down

Press to reduce the flame brightness. Toggle between OFF, F1 to F6 brightness setting.

### Volume down

Press to reduce the crackling fire sound effect. Toggle between OFF, VOL1 to VOL6 brightness setting.

### Ambient Cycle

Press to cycle through various ambient setting from AMB1 to AMB7. AMB8 is unlockable through the app.

### Time Cycle

The timer button increases the timer by 0.5hrs on each press. Up to 8hrs cycle.

### Heat Mode

Press the button to switch the heat mode on and off

### Temperature Up

Press this button to increase the temperature. Highest temperature can be set to 32°C.

### Flame brightness up

Press to increase the flame brightness. Toggle between OFF, F1 to F6 brightness setting.

### Volume up

Press to increase the crackling fire sound effect. Toggle between OFF, VOL1 to VOL6 brightness setting.

### Light Selection Button

Toggle through the various light setting for the top light, fuel beds and flame colour setting. Ranging from ON to LGT4.

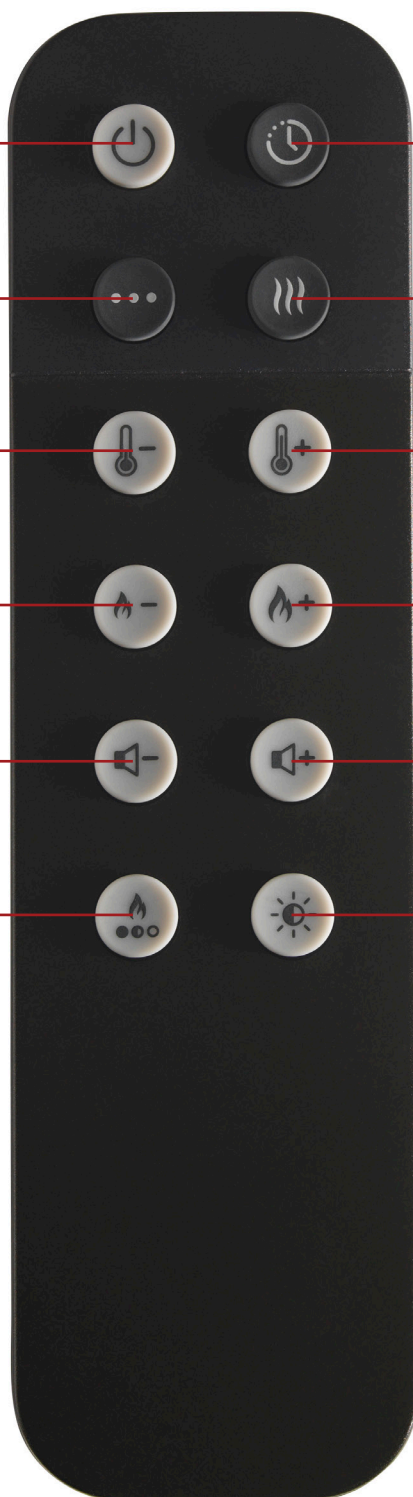

## FLAME CONNECT APP

Flame Connect is a new app that places full control of your electric fire into a beautiful, easy and convenient interface, all from the palm of your hand. The app is available on Android and iOS.

Enjoy the latest flame technology and ultra-realistic flame effects to create a unique and stunning focal point within any room.

- Simply scan and connect to Bluetooth to communicate directly with your fire.
- Quickly change modes and settings on your fire to suit your mood.
- Set product schedules to automate your fire's on/off times.
- Change flame effect settings and LED colours.
- Prevent unauthorised product access by linking ownership of your fire with your account.
- Enable guest mode for temporary access to other Flame Connect trusted users.
- Support for multiple languages and a choice of Fahrenheit and Celsius readout.

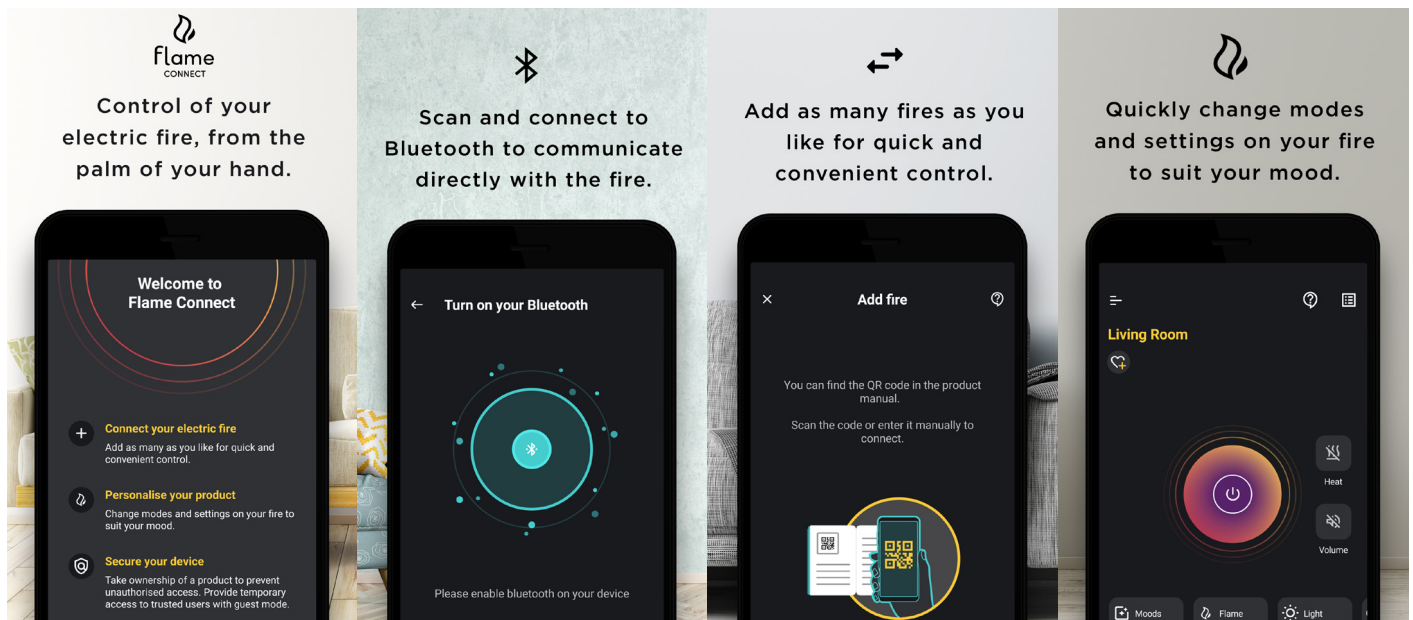

## MULTIPLE FIRE AND COLOUR EFFECT

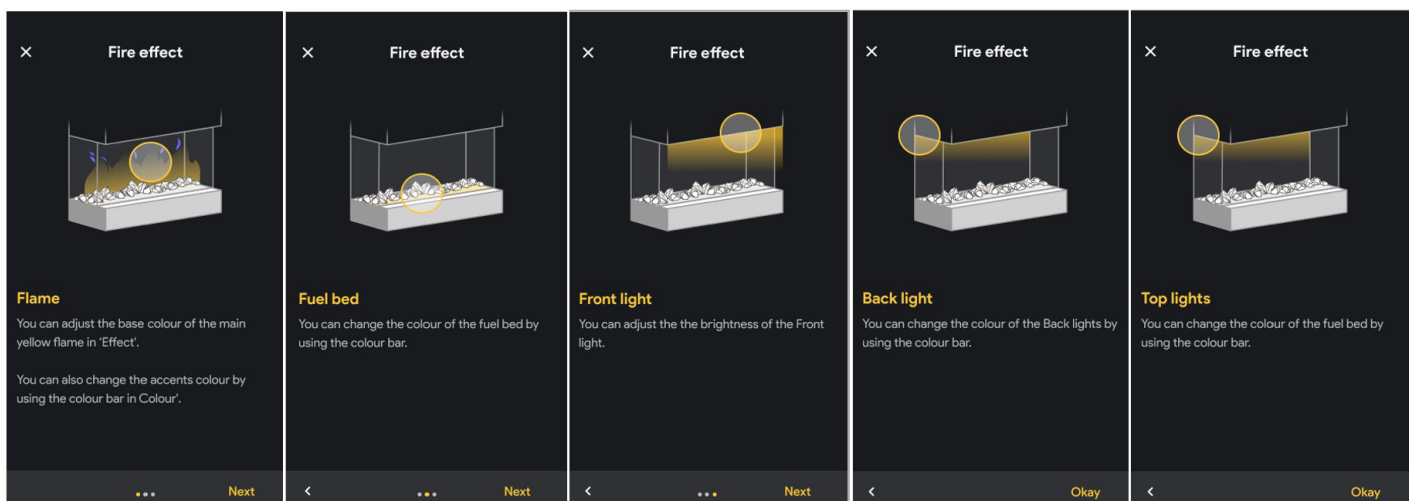

# UNIT AND INSTALLATION INFORMATION

## UNIT DIMENSIONS

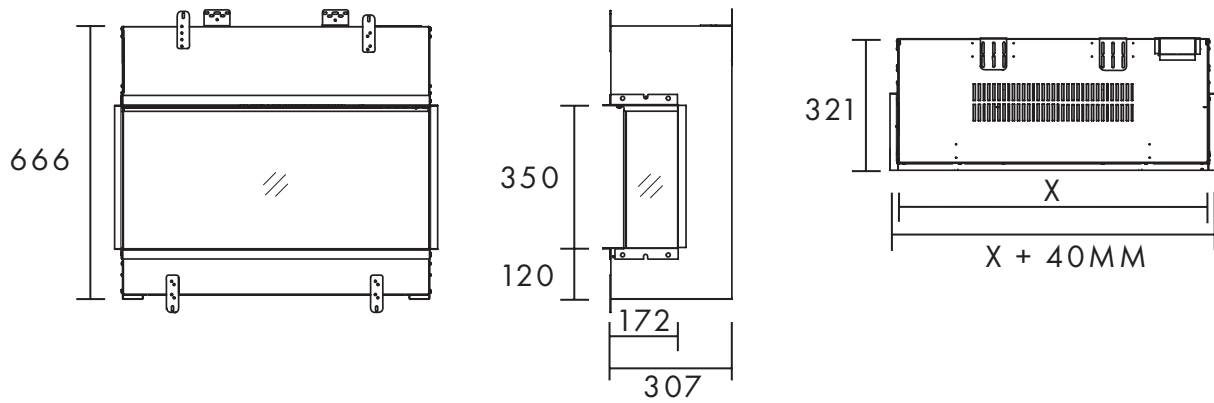

	VVT75-AU	VVT100-AU	VVT150-AU
X	753	1003	1503

## MINIMUM FRAMEOUT DIMENSIONS

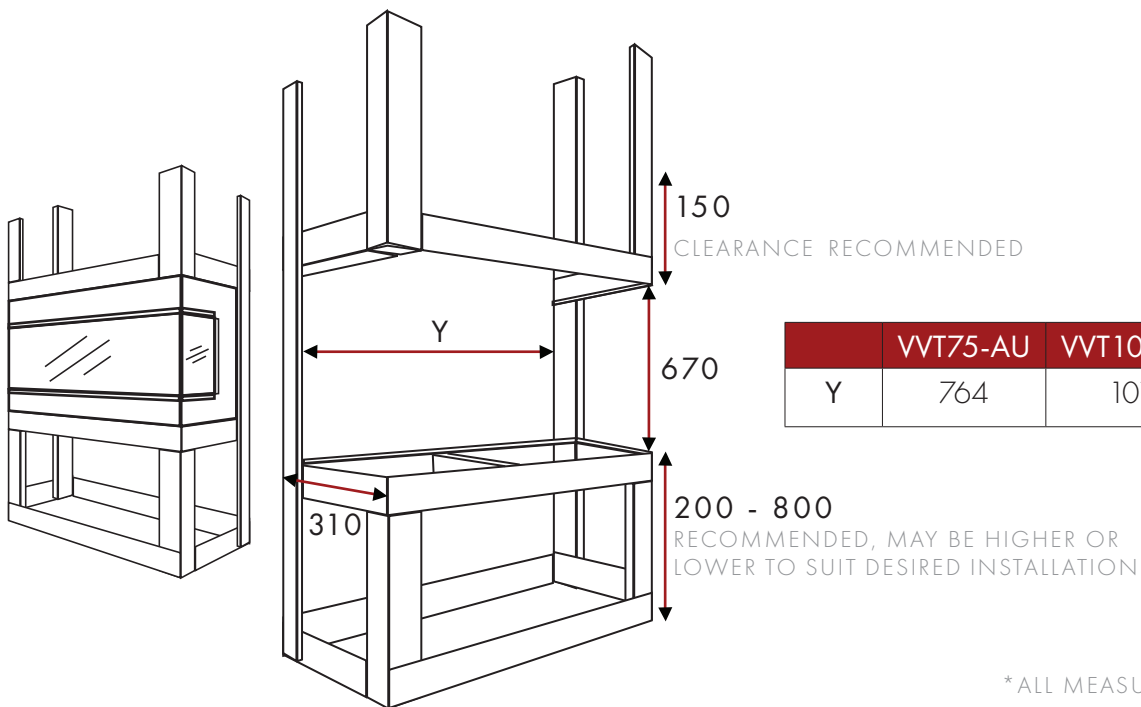

	VVT75-AU	VVT100-AU	VVT150-AU
Y	764	1014	1514

\*ALL MEASUREMENTS ARE IN MM



## SUPPORTING COLLATERAL

Brochure

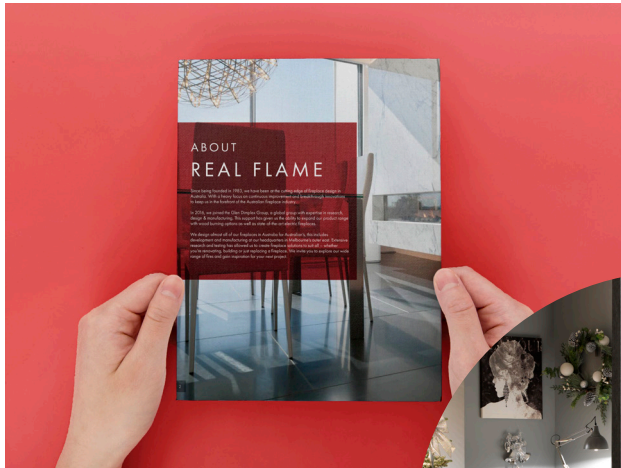

IOM



Images



Video

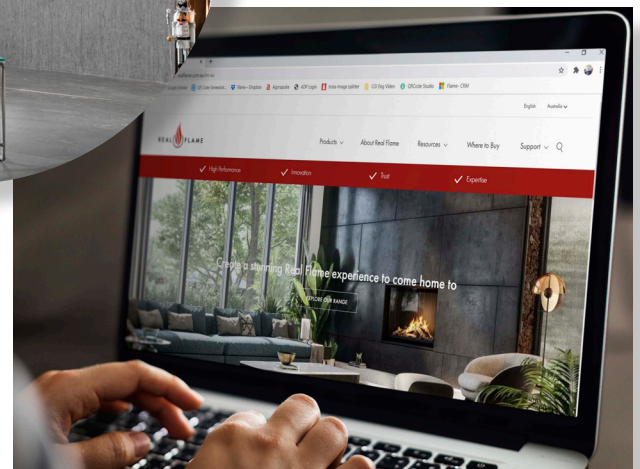

VIVENTE Web page

Please [CLICK HERE](#) to access all these resources that are at your disposal.

Contact your Real Flame representative for further clarifications and queries.





---

[www.realflame.com.au](http://www.realflame.com.au)

1300 554 155